



8" (200 mm)

Stainless Steel Submersible Pumps

60 Hz.

Product Data

Materials: 8" submersible pump

Sectional drawing: 8" submersible pump

Pos.	Component	Material	8 inch
			"VP" pump
1	Bowl / Diffuser	Stainless steel	AISI 304
2	Impeller	Stainless steel	AISI 304
3	Neck ring	NBR	NBR
4	Shaft	Stainless steel	AISI 431
5	Couple	Stainless steel	AISI 304
6	Delivery casing	Stainless steel	AISI 304
7	Suction case	Stainless steel	AISI 304
8	Bearing bush	NBR	NBR
9	Strainer	Stainless steel	AISI 304
10	Connector	Stainless steel	-

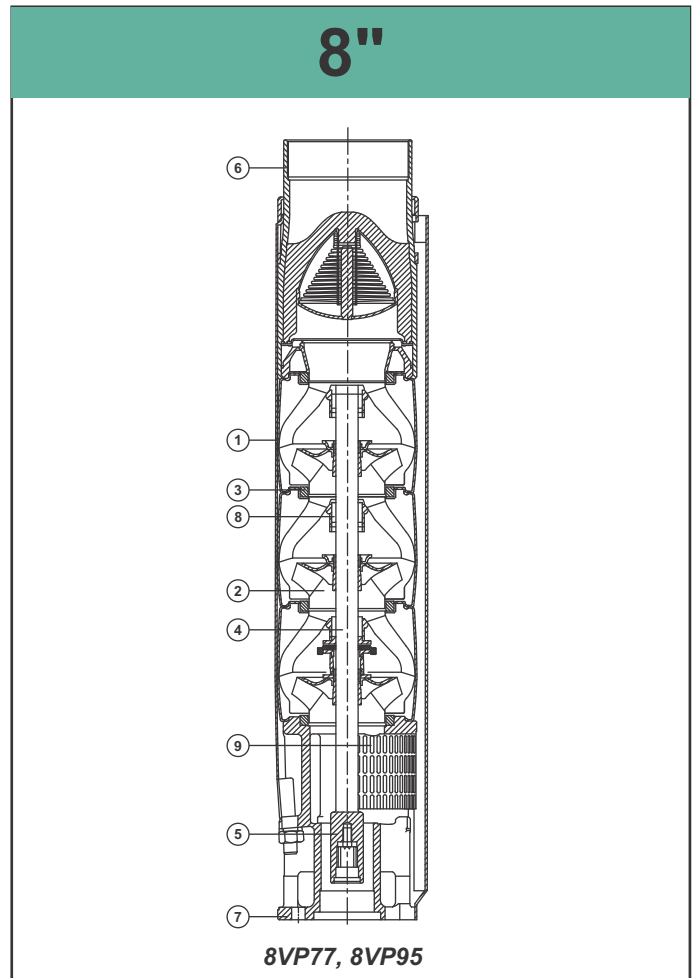

Direction of rotation

Clockwise as seen from the pump coupling side.



8VP77

Mixed Flow Pump Characteristic Curves & Technical Data

8"

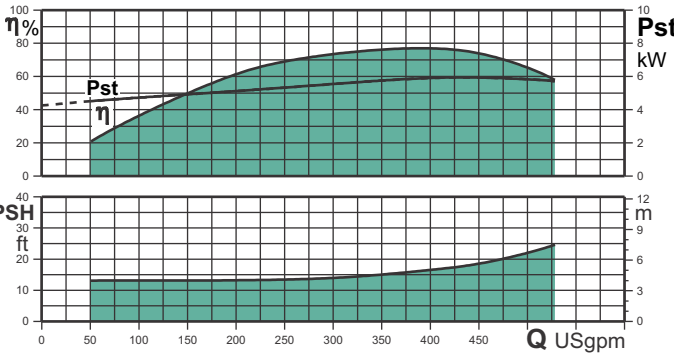
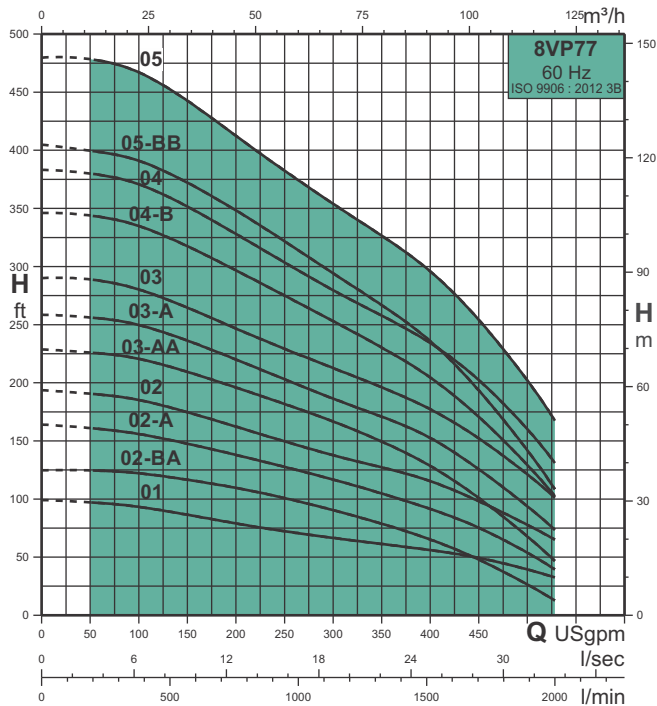

Pump type	P ₂		Q							
	HP	kW	0	167	333	833	1167	1500	1667	2000
8VP77-01	7,5	5,5	99	97	94	76	66	56	51	32
8VP77-02-BA	10	7,5	125	125	123	106	89	66	52	13
8VP77-02-A	12,5	9,3	164	161	157	134	115	93	79	39
8VP77-02	15	11	194	191	187	157	136	116	102	65
8VP77-03-AA	17,5	13	229	226	222	190	164	130	107	47
8VP77-03-A	20	15	259	257	252	213	184	154	131	73
8VP77-03	25	18,5	290	289	283	240	210	179	157	101
8VP77-04-B	25	18,5	346	344	338	288	249	207	178	102
8VP77-04	30	22	383	381	374	318	276	236	209	131
8VP77-05-BB	30	22	405	400	394	338	290	239	202	108
8VP77-05	35	26	480	479	471	400	349	299	263	167

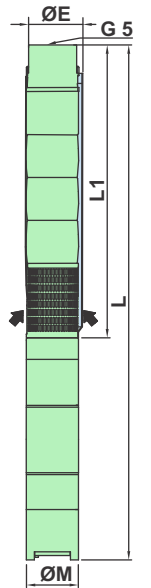
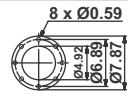

Nominal flow rate	396 USgpm
Flow range	50 - 528 USgpm
Head range	Up to 1427 Feet
Max. pump efficiency (η)	77%
Motor power	7,5 - 125 HP
Rated speed	3450 rpm
Pipe connection	G 5

Pump type	P ₂		Dimensions [inch]						Gross weight [lbs]			Gross volume [ft ³]		
			WF motor						Pump	Pump + WFM		Pump	Pump + WFM	
	HP	kW	Size	ØM	ØE	L1	L			1 ~	3 ~		1 ~	3 ~
	1 ~	3 ~												
8VP77-01	7,5	5,5	6"	5,59	7,01	24,33	-	51,02	52	-	176	1,1	-	3,0
8VP77-02-BA	10	7,5	6"	5,59	7,01	29,37	-	57,24	61	-	194	1,3	-	3,2
8VP77-02-A	12,5	9,3	6"	5,59	7,01	29,37	-	59,21	61	-	205	1,3	-	3,2
8VP77-02	15	11	6"	5,59	7,01	29,37	-	60,79	61	-	214	1,3	-	3,2
8VP77-03-AA	17,5	13	6"	5,59	7,01	34,41	-	67,20	70	-	232	1,4	-	3,4
8VP77-03-A	20	15	6"	5,59	7,01	34,41	-	68,39	70	-	237	1,4	-	3,4
8VP77-03	25	18,5	6"	5,59	7,01	34,41	-	71,14	70	-	256	1,4	-	3,8
8VP77-04-B	25	18,5	6"	5,59	7,01	39,45	-	76,18	78	-	265	1,6	-	4,0
8VP77-04	30	22	6"	5,59	7,01	39,45	-	78,54	78	-	278	1,6	-	4,0
8VP77-05-BB	30	22	6"	5,59	7,01	44,49	-	83,58	87	-	287	1,8	-	4,1
8VP77-05	35	26	6"	5,59	7,01	44,49	-	85,94	87	-	306	1,8	-	4,1

Note: ØE = For single cable motor maximum diameter of pump inclusive of cable guard.

For two cable motor maximum diameter of pump inclusive of cable guard will increase by 0,16".

All dimensions in inches unless otherwise noted.



8VP77

Mixed Flow Pump Characteristic Curves & Technical Data

8"

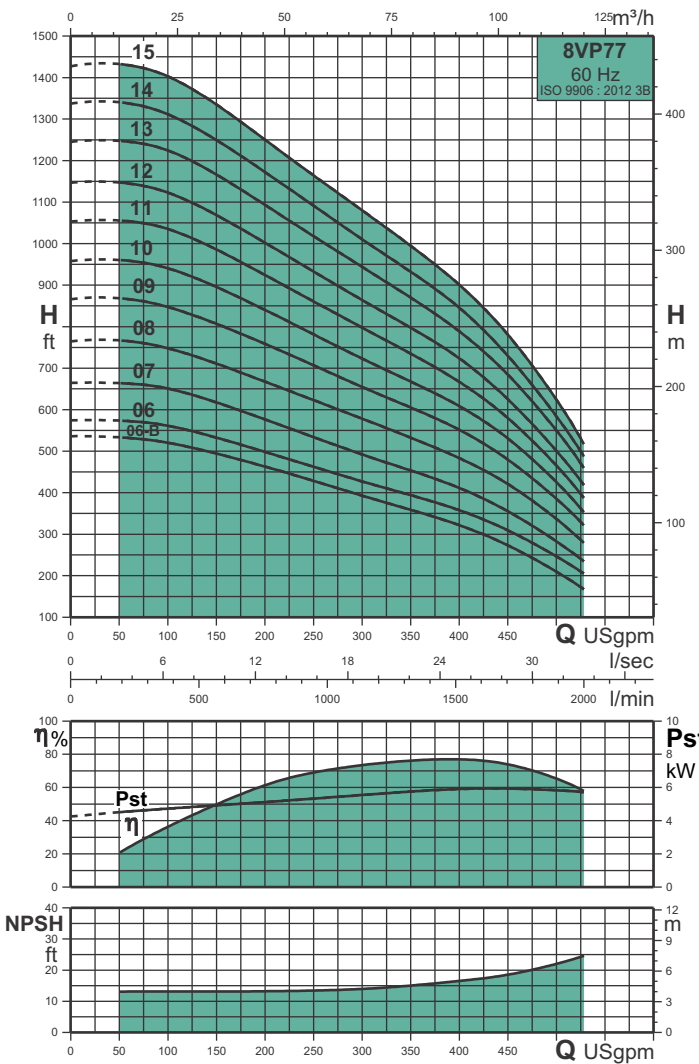

Pump type	P ₂		Q								
	HP	kW	0	167	333	833	1167	1500	1667	2000	
			Q USgpm	0	44	88	220	308	396	440	528
8VP77-06-B	40	30	H ft	536	534	525	449	387	325	284	167
8VP77-06	50	37		574	574	566	484	422	361	320	205
8VP77-07	50	37		664	664	656	559	486	415	367	235
8VP77-08	60	45		764	768	755	650	571	487	435	279
8VP77-09	75	55		866	869	855	738	646	556	495	322
8VP77-10	75	55		958	961	948	817	714	614	548	353
8VP77-11	90	66		1053	1056	1043	899	787	673	599	387
8VP77-12	90	66		1147	1148	1132	974	853	730	646	418
8VP77-13	100	75		1245	1248	1234	1063	932	796	707	459
8VP77-14	125	93		1337	1342	1322	1140	997	853	755	487
8VP77-15	125	93		1427	1434	1414	1216	1066	909	807	517

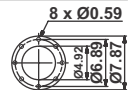

Nominal flow rate	396 USgpm
Flow range	50 - 528 USgpm
Head range	Up to 1427 Feet
Max. pump efficiency (η)	77%
Motor power	7,5 - 125 HP
Rated speed	3450 rpm
Pipe connection	G 5

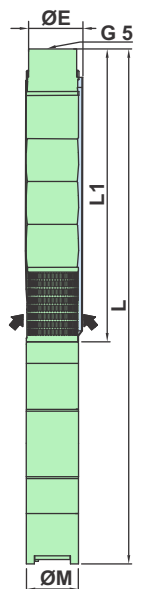

Pump type	P ₂		Dimensions [inch]						Gross weight [lbs]			Gross volume [ft ³]		
			WF motor						Pump	Pump + WFM		Pump	Pump + WFM	
	HP	kW	Tamaño Size Taille	ØM	ØE	L1	L			1 ~	3 ~		1 ~	3 ~
							1 ~	3 ~						
8VP77-06-B	40	30	6"	5,59	7,01	49,53	-	94,13	96	-	343	2,0	-	6,7
8VP77-06	50	37	6"	5,59	7,01	49,53	-	96,10	96	-	369	2,0	-	6,7
8VP77-07	50	37	6"	5,59	7,01	54,57	-	101,14	105	-	378	2,2	-	6,9
8VP77-08	60	45	8"	7,48	7,87	60,16	-	107,80	113	-	585	2,4	-	9,9
8VP77-09	75	55	8"	7,48	7,87	65,20	-	114,80	122	-	625	2,6	-	10,3
8VP77-10	75	55	8"	7,48	7,87	70,24	-	119,84	131	-	633	2,7	-	10,5
8VP77-11	90	66	8"	7,48	7,87	75,28	-	131,46	219	-	808	8,0	-	16,6
8VP77-12	90	66	8"	7,48	7,87	80,31	-	136,50	231	-	820	8,5	-	17,1
8VP77-13	100	75	8"	7,48	7,87	85,35	-	143,50	244	-	857	9,0	-	17,9
8VP77-14	125	93	8"	7,48	7,87	102,20	-	165,87	256	-	929	9,5	-	19,0
8VP77-15	125	93	8"	7,48	7,87	107,24	-	170,91	269	-	941	10,0	-	19,5

Note: ØE = For single cable motor maximum diameter of pump inclusive of cable guard.
For two cable motor maximum diameter of pump inclusive of cable guard will increase by 0,16".
All dimensions in inches unless otherwise noted.



8VP95

Mixed Flow Pump Characteristic Curves & Technical Data

8"

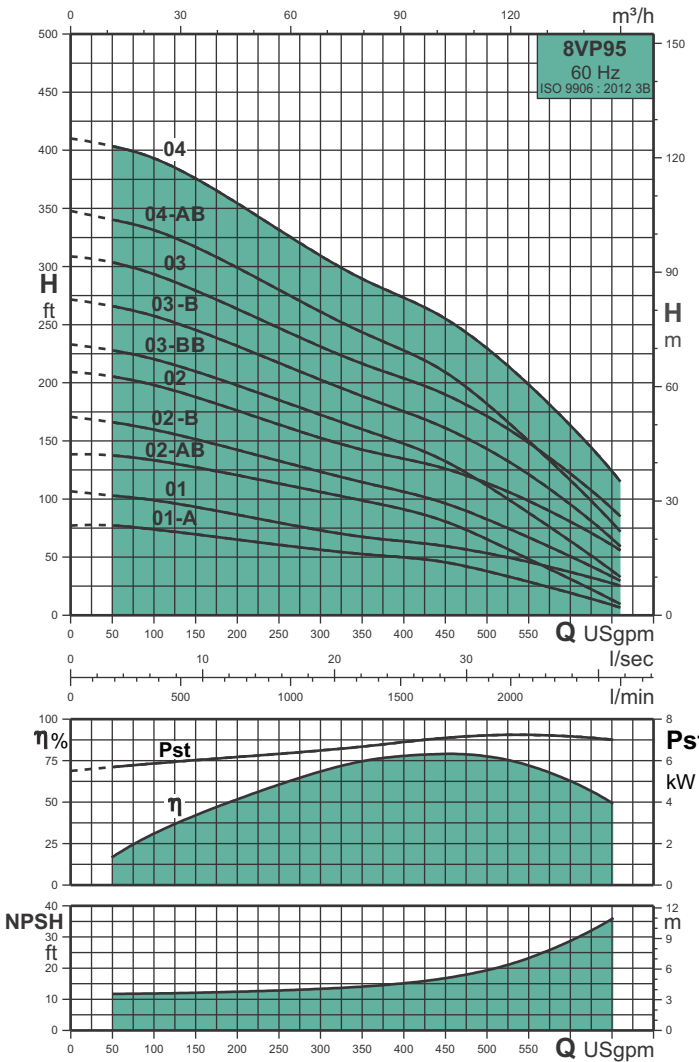

Pump type	P ₂		Q							
	HP	kW	0	167	333	1333	1667	2000	2500	
8VP95-01-A	7,5	5,5	77	77	75	52	47	33	7	
8VP95-01	10	7,5	107	103	100	67	60	49	25	
8VP95-02-AB	12,5	9,3	138	138	135	98	83	56	10	
8VP95-02-B	15	11	171	167	161	114	98	74	30	
8VP95-02	17,5	13	209	206	200	142	128	105	56	
8VP95-03-BB	20	15	233	229	222	159	136	98	33	
8VP95-03-B	25	18,5	272	267	260	188	164	131	59	
8VP95-03	30	22	309	304	296	216	193	159	85	
8VP95-04-AB	30	22	348	341	334	243	213	164	72	
8VP95-04	35	26	410	405	396	289	259	213	115	

Nominal flow rate	462 USgpm
Flow range	50 - 660 USgpm
Head range	Up to 1309 Feet
Max. pump efficiency (η)	79%
Motor power	7,5 - 125 HP
Rated speed	3450 rpm
Pipe connection	G 5

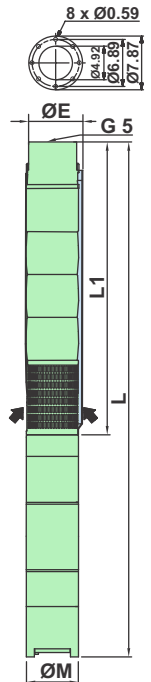

Pump type	P ₂		Dimensions [inch]						Gross weight [lbs]			Gross volume [ft ³]		
			WF motor						Pump	Pump + WFM		Pump	Pump + WFM	
	HP	kW	Size	ØM	ØE	L1	L			1 ~	3 ~		1 ~	3 ~
	1 ~	3 ~												
8VP95-01-A	7,5	5,5	6"	5,59	7,01	24,33	-	51,02	52	-	176	1,1	-	3,0
8VP95-01	10	7,5	6"	5,59	7,01	24,33	-	52,20	52	-	185	1,1	-	3,0
8VP95-02-AB	12,5	9,3	6"	5,59	7,01	29,37	-	59,21	61	-	205	1,3	-	3,2
8VP95-02-B	15	11	6"	5,59	7,01	29,37	-	60,79	61	-	214	1,3	-	3,2
8VP95-02	17,5	13	6"	5,59	7,01	29,37	-	62,17	61	-	223	1,3	-	3,2
8VP95-03-BB	20	15	6"	5,59	7,01	34,41	-	68,39	70	-	237	1,4	-	3,4
8VP95-03-B	25	18,5	6"	5,59	7,01	34,41	-	71,14	70	-	256	1,4	-	3,8
8VP95-03	30	22	6"	5,59	7,01	34,41	-	73,50	70	-	269	1,4	-	3,8
8VP95-04-AB	30	22	6"	5,59	7,01	39,45	-	78,54	78	-	278	1,6	-	4,0
8VP95-04	35	26	6"	5,59	7,01	39,45	-	80,91	78	-	297	1,6	-	4,0

Note: ØE = For single cable motor maximum diameter of pump inclusive of cable guard.
For two cable motor maximum diameter of pump inclusive of cable guard will increase by 0,16".
All dimensions in inches unless otherwise noted.



8VP95

Mixed Flow Pump Characteristic Curves & Technical Data

8"

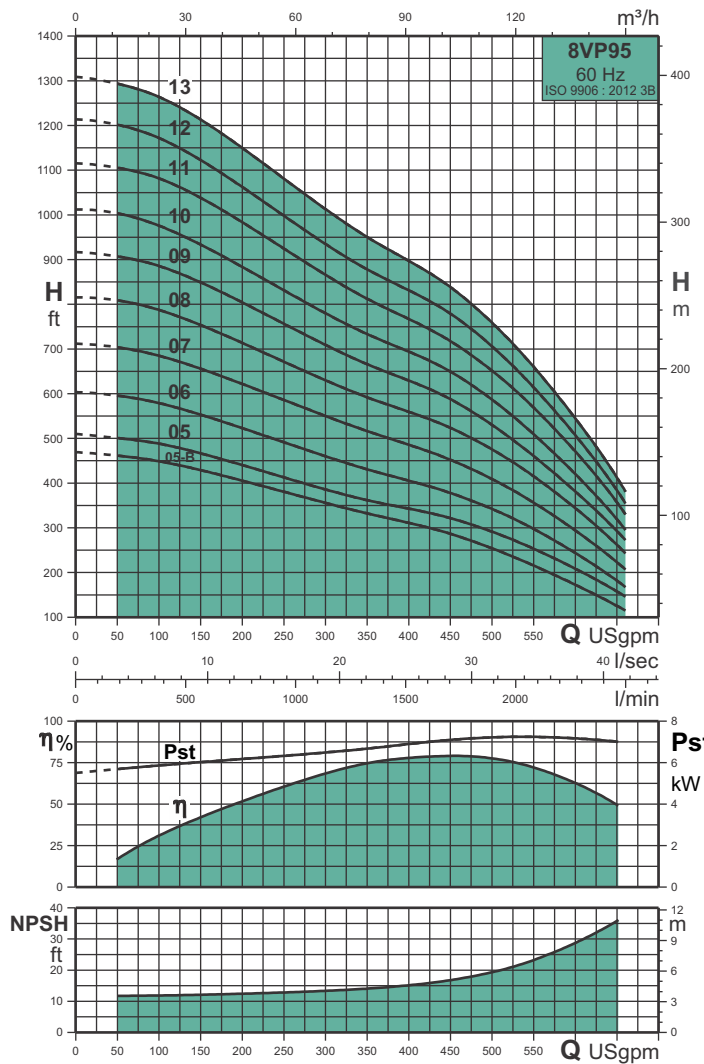

Pump type	P ₂		Q							
	HP	kW	0	167	333	1333	1667	2000	2500	
			Q USgpm	0	44	88	352	440	528	660
8VP95-05-B	40	30	H ft	469	463	453	331	292	233	115
8VP95-05	50	37		510	502	492	361	326	271	146
8VP95-06	50	37		604	597	584	430	384	318	167
8VP95-07	60	45		712	705	691	515	459	381	207
8VP95-08	75	55		815	810	794	591	531	443	243
8VP95-09	90	66		917	909	892	664	597	492	272
8VP95-10	90	66		1012	1006	984	732	659	545	295
8VP95-11	100	75		1115	1107	1089	810	728	607	330
8VP95-12	125	93		1214	1204	1181	876	791	656	354
8VP95-13	125	93		1309	1296	1273	948	851	705	381

Nominal flow rate	462 USgpm
Flow range	50 - 660 USgpm
Head range	Up to 1309 Feet
Max. pump efficiency (η)	79%
Motor power	7,5 - 125 HP
Rated speed	3450 rpm
Pipe connection	G 5

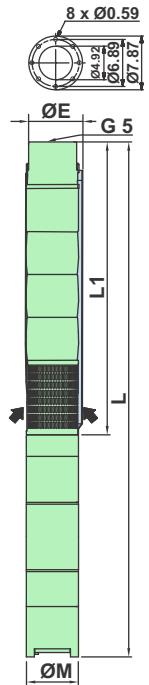

Pump type	P ₂		Dimensions [inch]						Gross weight [lbs]			Gross volume [ft³]		
			WF motor						Pump	Pump + WFM		Pump	Pump + WFM	
	HP	kW	Size	ØM	ØE	L1	L			1 ~	3 ~		1 ~	3 ~
							1 ~	3 ~						
8VP95-05-B	40	30	6"	5,59	7,01	44,49	-	89,09	87	-	334	1,8	-	6,5
8VP95-05	50	37	6"	5,59	7,01	44,49	-	91,06	87	-	361	1,8	-	6,5
8VP95-06	50	37	6"	5,59	7,01	49,53	-	96,10	96	-	369	2,0	-	6,7
8VP95-07	60	45	8"	7,48	7,87	55,12	-	102,76	105	-	577	2,2	-	9,7
8VP95-08	75	55	8"	7,48	7,87	60,16	-	109,76	113	-	616	2,4	-	10,2
8VP95-09	90	66	8"	7,48	7,87	65,20	-	121,38	122	-	711	2,6	-	11,1
8VP95-10	90	66	8"	7,48	7,87	70,24	-	126,42	131	-	719	2,7	-	11,3
8VP95-11	100	75	8"	7,48	7,87	75,28	-	133,43	219	-	832	8,0	-	16,9
8VP95-12	125	93	8"	7,48	7,87	80,31	-	143,98	231	-	904	8,5	-	18,0
8VP95-13	125	93	8"	7,48	7,87	85,35	-	149,02	244	-	916	9,0	-	18,5

Note: ØE = For single cable motor maximum diameter of pump inclusive of cable guard.
For two cable motor maximum diameter of pump inclusive of cable guard will increase by 0,16".

All dimensions in inches unless otherwise noted.

